

AiKON
DISTRIBUTION

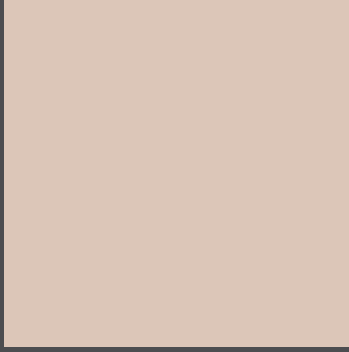
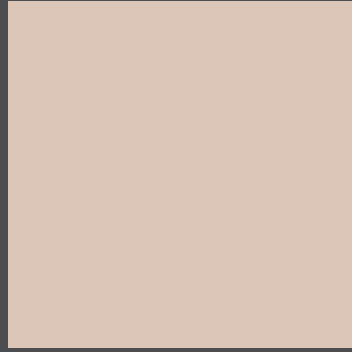
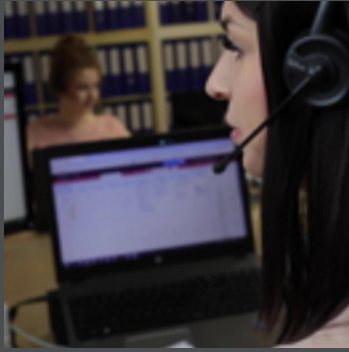

TIMBER WINDOWS AND DOORS

Product catalogue

TYPES OF TIMBER

PINE TIMBER



Pine timber is durable, strong and offers excellent thermal insulation. Its high resin content makes it resistant to the damaging effects of moisture. It has a light colour and saturates well with paints and varnishes.

MERANTI TIMBER



An exotic timber species that combines very good thermal and acoustic parameters with an interesting design. Doors made of meranti timber are more durable and long-lasting than those made of pine.

OAK TIMBER



Oak timber is hard, very durable and resistant to abrasion and mechanical damage. It is also distinguished by extremely good soundproofing. It is distinguished by its durability and resistance to changing external conditions. In addition, it has an interesting colour and grain pattern, which makes oak doors enduringly popular.

The colours presented in the catalogue only approximate the actual colours of the product.

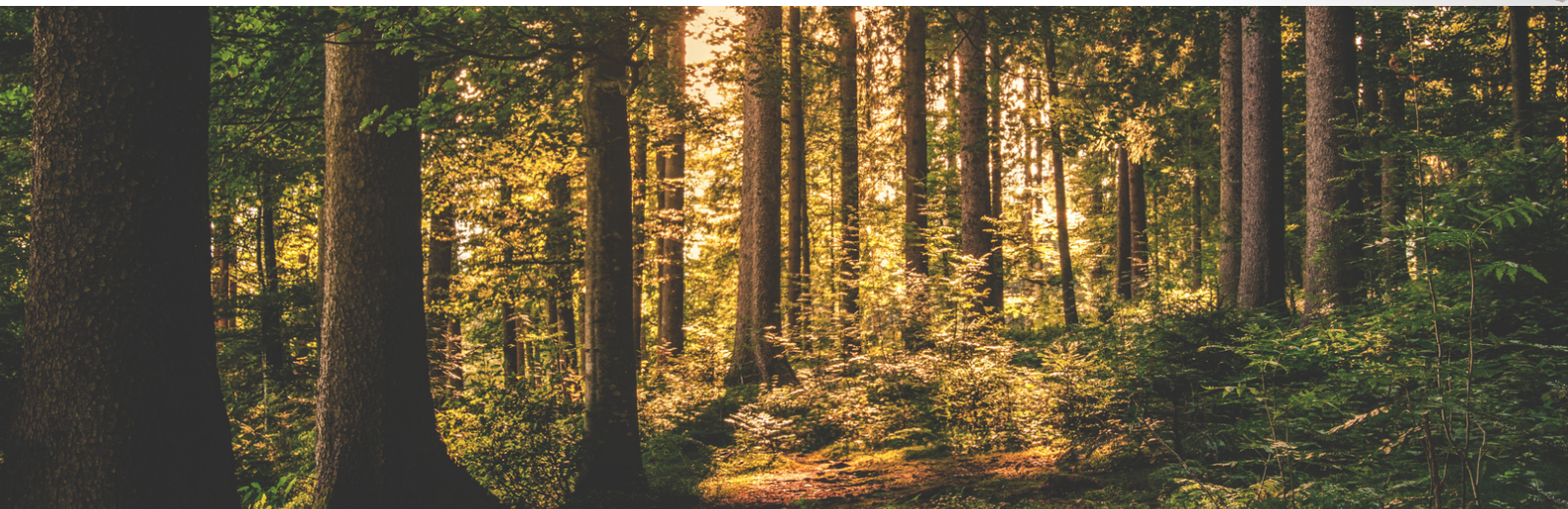

ECOLINE

Timber window profiles



TERRACE

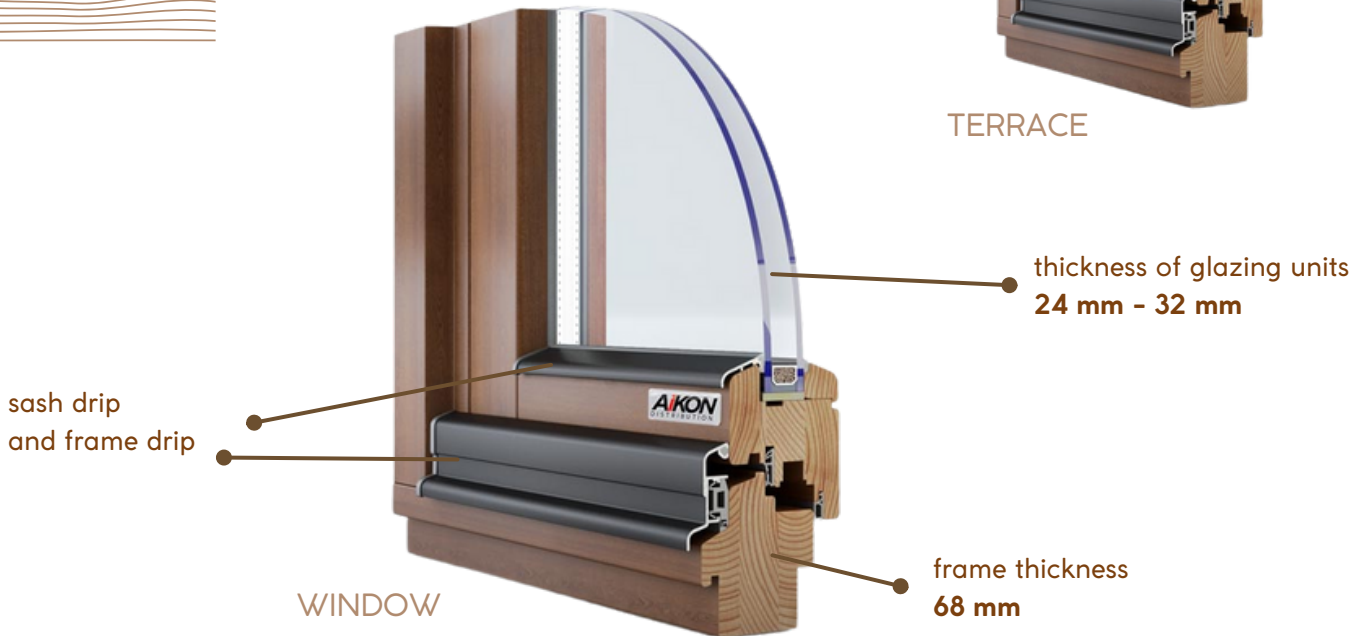

WINDOW

A timber window with a frame thickness of 68 millimeters, distinguished by an elegant, rounded line. The frame and sash are made of the best quality, technologically processed and 3-layer glued timber. The window is sealed with an internal gasket, made of durable and robust EPDM rubber. The sash drips and frame drip edges are standard equipment of the Ecoline window.

TECHNICAL DATA

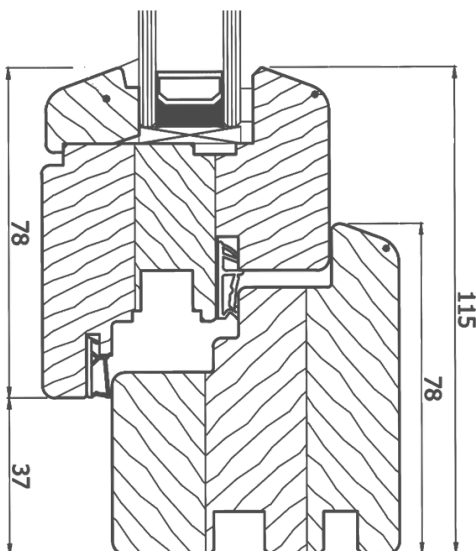

Frame thickness **68 mm**

Heat transfer coefficient **Uf=1,4 W/m²*K**

Gasket **Single internal EPDM**

Available thickness of glazing units **24 mm - 32 mm**

Standard glazing **4/16Ar/4 [Rw=32dB, Lt=82%, g=65%]**

Profile structure **3-layer glued scantling**

Standard handle **Hoppe Secustic**

Warranty **5 years on the structure**

Certifications **CE, ITB, ITT, FSC**

Other standard accessories **sash drip + frame drip edge**

Turnaround **9 - 14 weeks**



UPAIX
Southern France



The photos show a beautiful timber house located in Upaix, in the Provence-Alpes-Côte d'Azur region. It was assembled with timber windows of various sizes, shapes and opening methods, PSK sliding doors and a front door. All this joinery was based on the **Ecoline** profile and kept in a dark brown colour.

The house presents a harmonious combination of modernity and tradition, where timber window joinery elements perfectly harmonize with the natural surroundings.

ECOLINE + ALUMINIUM

Timber window profiles

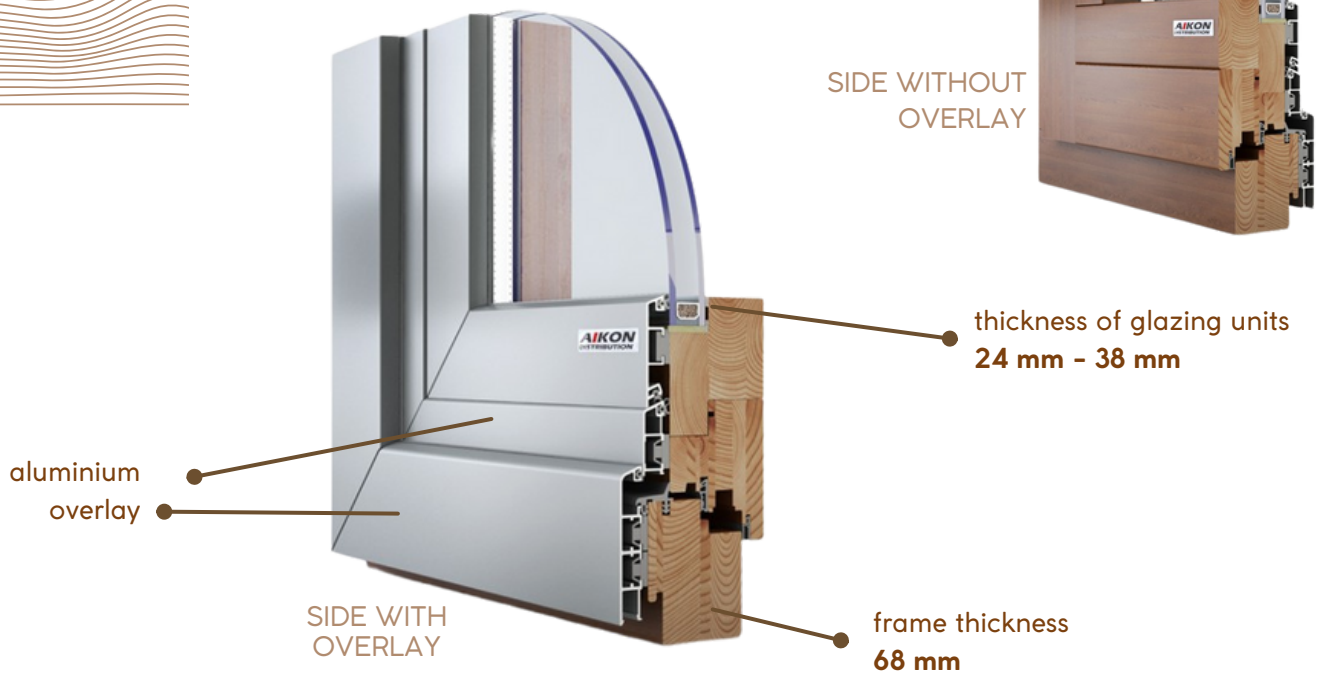

Timber windows and doors with aluminium overlay are equipped with three-layer glued frames, which ensures their high resistance to weather conditions. Modern design and a wide range of RAL colours make timber-aluminium windows blend perfectly with different types of facades. Ecoline system is a warranty of good price for timber-aluminium windows.

TECHNICAL DATA

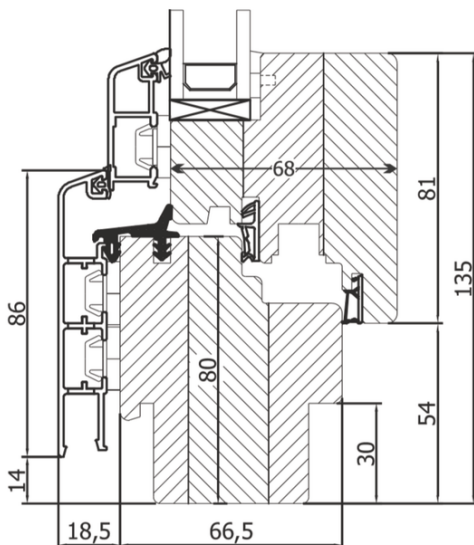

Frame thickness **68 mm**

Heat transfer coefficient **Uf=1,4 W/m²*K**

Gasket **Single internal EPDM gasket**

Available thickness of glazing units **24 mm - 32 mm**

Standard glazing **4/16Ar/4 [Rw=32dB, Lt=82%, g=65%]**

Profile structure **3-layer glued scantling**

Standard handle **Hoppe Secustic**

Warranty **5 years on the structure**

Certifications **CE, ITB, LTB, FSC**

Other standard accessories **aluminium overlay**

Turnaround **9 - 14 weeks**

The aluminum overlay can be applied to any tilt-and-turn timber profile offered by Aikon Distribution.

Ask the salesperson for details!

THERMOLINE

Timber window profiles



TERRACE



A timber window with an frame thickness of 78 millimeters, characterized by a more durable structure and better thermal and acoustic insulation than standard windows. The frame and sash are made of the best quality, technologically processed and 4-layer glued timber. The window is sealed with an internal gasket, made of durable and robust EPDM rubber.

TECHNICAL DATA

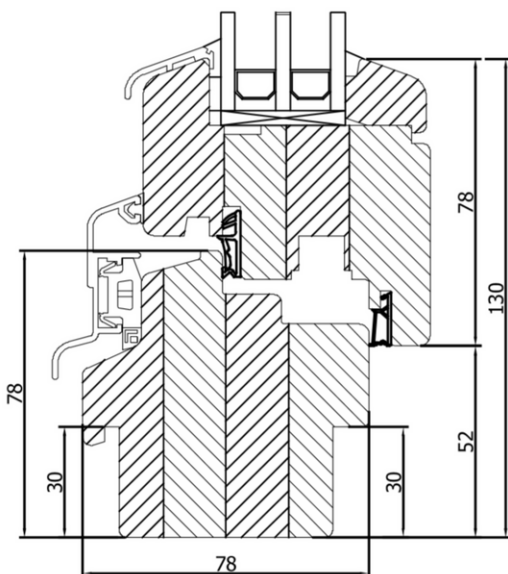

Frame thickness **78 mm**

Heat transfer coefficient **Uf=1,2 W/m2+K**

Gasket **Single internal with EPDM**

Available thickness of glazing units **20mm - 44mm**

Standard glazing **4/12Ar/4/12/Ar/4 (Rw=32dB, Lt=71%, g=50%)**

Profile structure **4-layer glued scantling**

Standard handle **Hoppe Secustic**

Warranty **5 years on the structure**

Certifications **CE, ITB, LTB, FSC**

Other standard accessories **Gap sash drip + frame drip edge**

Turnaround **9 - 14 weeks**

* double glazing as standard

ECOTHERM

Timber window profiles



TERRACE



WINDOW

EcoTherm92 windows were created with passive construction solutions in mind. Big frame thickness and sash profile makes it possible to obtain a structure with very high rigidity, and the 4-layer painting system perfectly protects timber against weather conditions.

TECHNICAL DATA

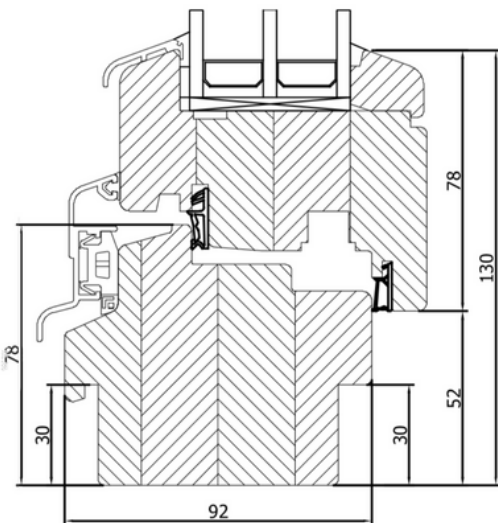

Frame thickness **92 mm**

Heat transfer coefficient **Uf=1,0 W/m²*K**

Gasket **Double middle with EPDM**

Available thickness of glazing units **24 mm- 56 mm**

Standard glazing **4/12Ar/4/12/Ar/4 (Rw=32dB, Lt=71%, g=50%)**

Profile structure **4-layer glued scantling**

Standard handle **Hoppe Secustic**

Warranty **5 years on the structure**

Certifications **CE, ITB,LTB, FSC**

Other standard accessories **sash drip + frame drip**

Turnaround **9 - 14 weeks**

Timber window profiles

RETRO



Windows on Ecoline 68, Thermoline 78 and Ecotherm 92 profiles can be made in retro style. They are mainly designed for buildings under conservation protection.



characteristic decorative additions



as well as a whole range of possibilities: muntins, milling in the window frame, hinge overlays, panels with application, milled panels

hinge edge

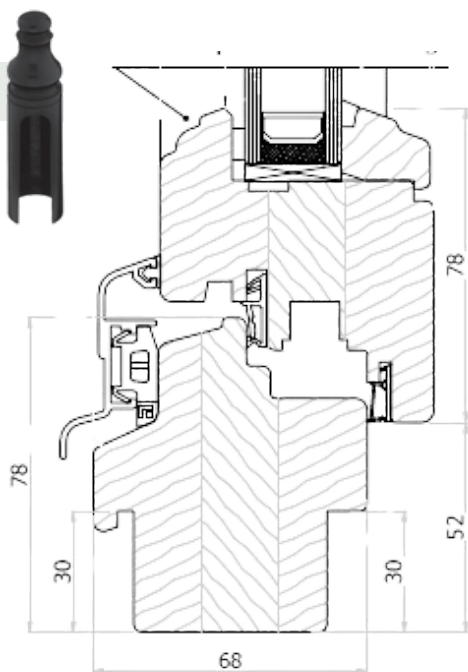



TROYES

Southern France



This beautiful townhouse is located in Troyes, a city on the Seine River. It was assembled with windows made of pine timber, based on the retro-style Ecoline profile. The windows are of different sizes, but all were painted white. Their appearance has been enhanced with custom muntins and beautiful, unusual handles.

The architecture of this townhouse blends in perfectly with the picturesque landscape of Troyes, and the retro-style timber windows add to its unique charm. Details such as custom muntins and elegant, unusual doorknobs highlight the attention to beauty and make this place exude a unique character.



RENOVATION

Renovation windows are a type of window particularly popular in the French and Italian markets. The renovation fin avoids complete disassembly of old windows, and covers all or part of the frames left behind. The solution works well, for example, when woodwork needs to be replaced in historic buildings.



Renovation undercuts in timber can be made on a 106 mm or 136 mm frame. The maximum height of the renovation milling is 35 or 40 mm, the maximum width depends on the thickness of the profile.

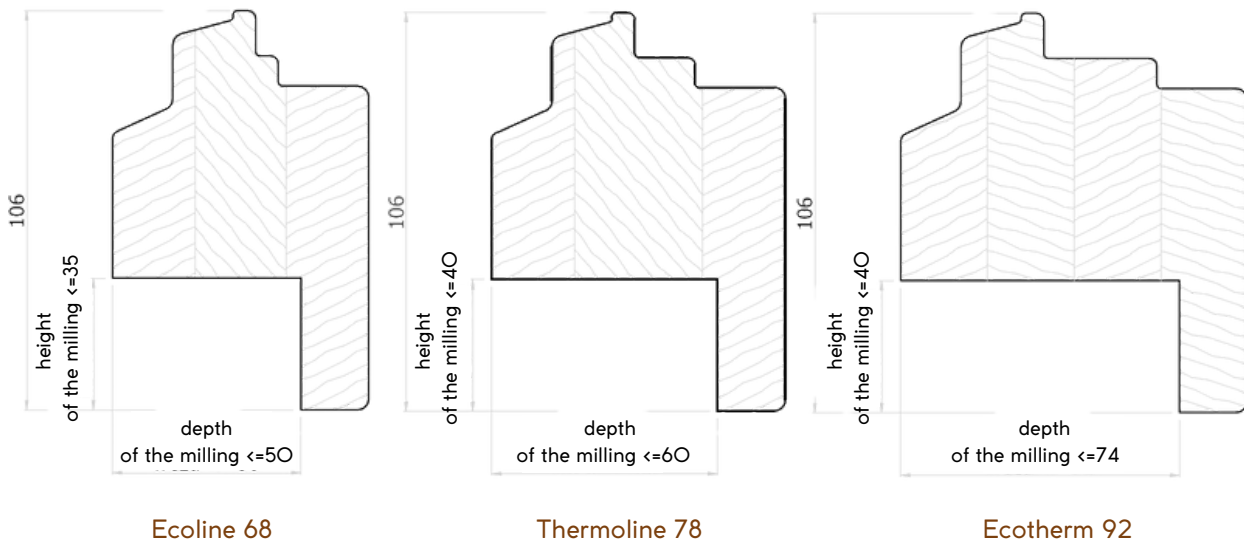

MONOBLOCK

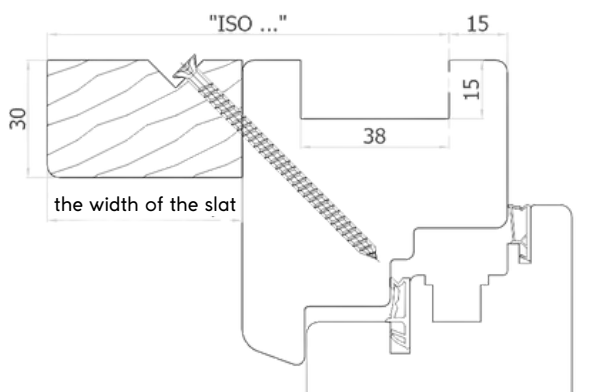

Monoblock frames are the most popular on the French market. They are designed for the construction of windows that are installed in the insulation layer. In order to construct a monoblock type frame:

- the sides and top deepen the window frame by tightening the slat (the so-called ISO),
- the sill is mounted at the bottom

FLUSH CASEMENT

Timber window profiles



FROM THE EXTERIOR



FROM THE INTERIOR

thickness of glazing units
24 mm

frame thickness
92 mm

Flush Casement windows have been designed to meet the requirements of the Scandinavian market as well as the UK and Ireland, where windows opening outwards dominate and are the most frequent choice of customers. Such a solution allows us to maintain the traditional beauty of windows characteristic for these regions, while paying attention to high safety standards. The 92mm frame structure ensures excellent rigidity of the window. As a standard, the windows are painted with 4 layers, which provides excellent protection, ensuring the perfect appearance of the windows for many years.

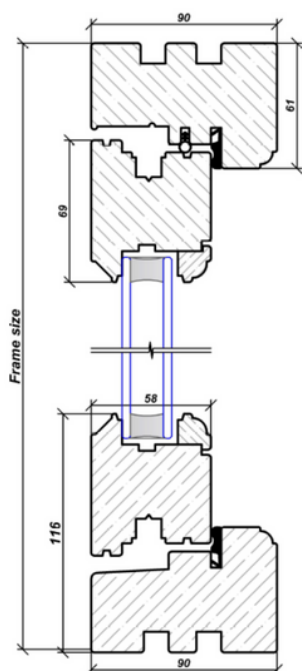

TECHNICAL DATA

Frame depth **92 mm**

Gasket **Double Q-Ion**

Available glazing unit thickness **24 mm**

Standard glazing **4/16Ar/4**

Standard handle **Virage handle simple with lock and key**

Warranty **5 years on the structure**

Certifications **CE, ITB, ITT, FSC**

Turnaround **9 - 14 weeks**

FLUSH CASEMENT

with bent Virage handle





We completed an unusual arched Scandinavian window for one of our clients.

The window was made of solid pine in RAL 7035 colour, i.e. soft ash. The window has a black Scandinavian bent window handle typical for this type of windows, plus black butterfly window hinges and a movable mullion.

The arched Scandinavian window is not only a functional architectural element, but also brings a modern and cozy atmosphere to the interior. The black handle, bent butterfly window hinges and movable mullion give this unusual window a unique character, creating a unique combination of elegance and innovative design.



Timber window profiles

SASH

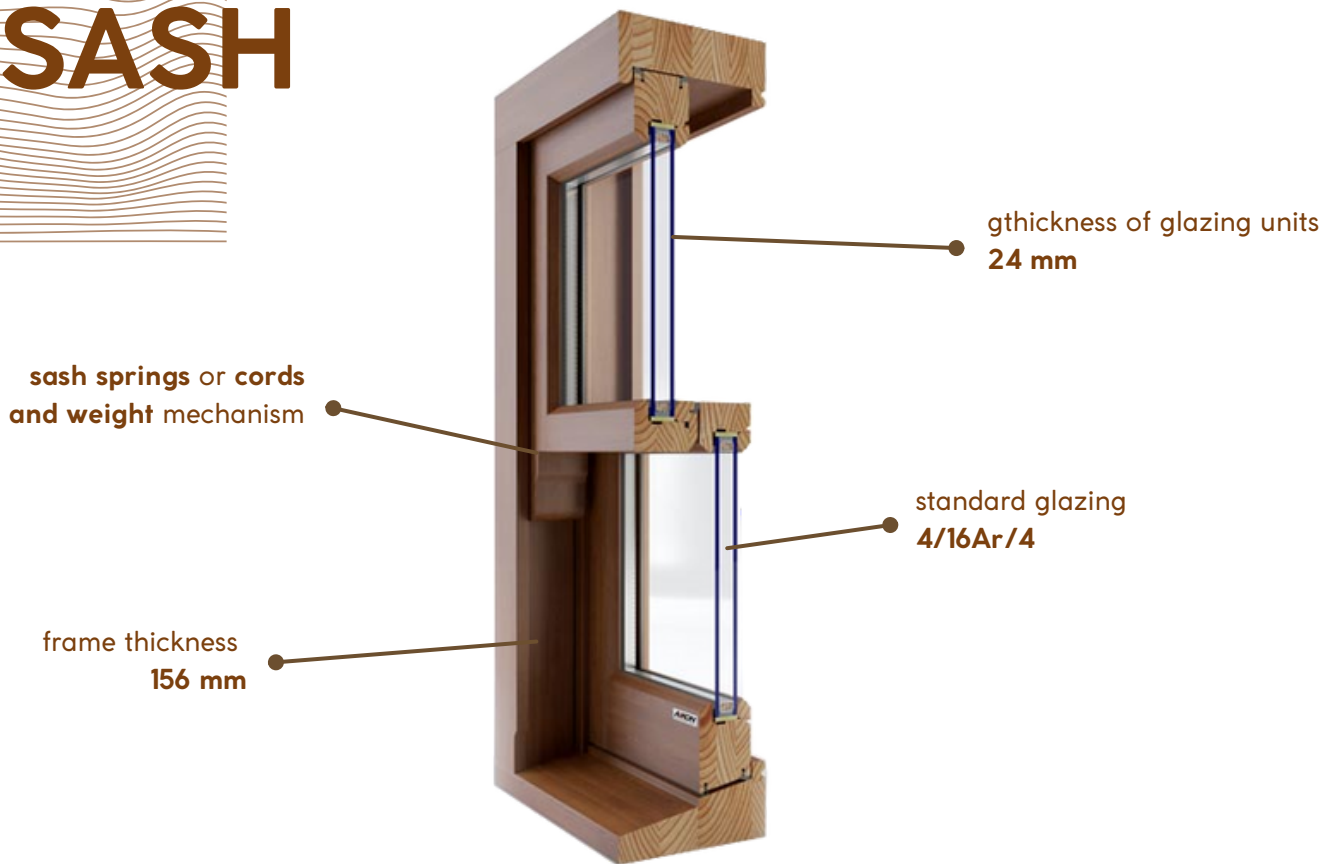

Sash windows have been designed for the UK and Irish market. Sash windows also called guillotine windows operate in an up-and-down sliding system.

TECHNICAL DATA

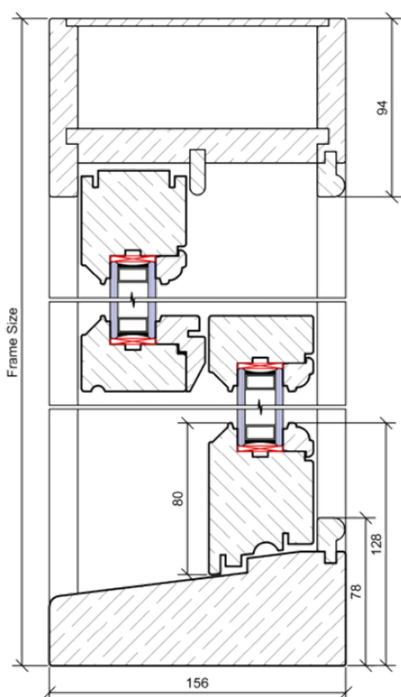

Frame thickness **156 mm**

Heat transfer coefficient **Uf=1,4 W/m2*K**

Gasket **TPE**

Available thickness of glazing units **24 mm**

Standard glazing **4/16Ar/4 (Rw=31dB, Lt=80%, g=63%)**

Other standard accessories **locks, catches, handles**

Warranty **5 years for the structure**

Certifications **CE, ITB, ITT, FSC**

Turnaround **5-8 weeks**

SASH AND CASEMENT WINDOW ELEMENTS

CASEMENT WINDOW HANDLES



Virage handle
simple
as standard



Virage handle
bent

colours of Virage handles

white, black, gold,
chrome, satin chrome



SASH WINDOW ELEMENTS



copper

brass
polished

chrome
polished

chrome
matt

white

SASH FITTINGS



Lock with key
Heritage



Pull handle
eyelet/ring



Pull handle
hook

SASH MECHANISM COMPONENTS

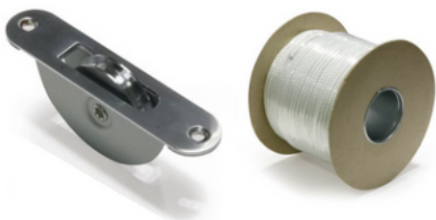

In a weighted mechanism

In the mechanism with weights, rollers and string are used.

In a spring mechanism

Springs come in white, gray, black, brown and cream colours. Standard used springs in white, other colours are available on request and extend production time. The springs are visible, it is possible to mask the inner springs with a slat.

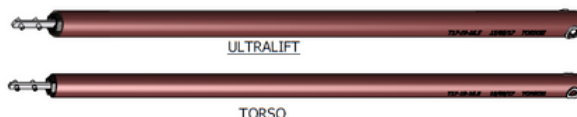

SASH WINDOW

with accessories in golden colour





SASH timber window in dark walnut colour is the quintessence of the highest quality and truly elegant style. The best quality materials were used in its production, which guarantee very good sound insulation and thermal comfort. In addition, chic gold accessories in the form of handrails, locks and movement stops make the SASH window delightful not only in its functionality, but also in its fascinating appearance.



ENTRY DOORS

Timber

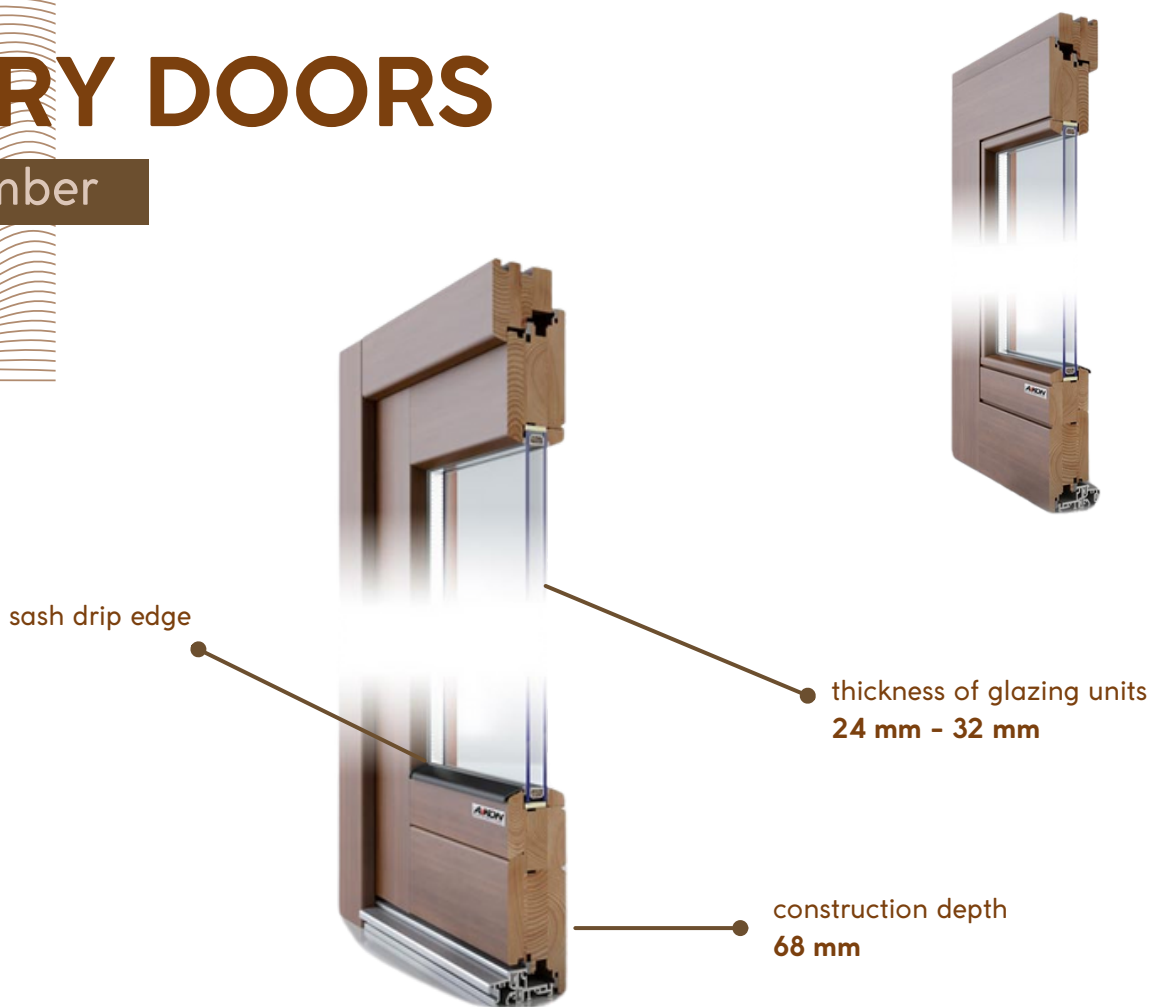

Timber front door is one of the most classic solutions, perfectly corresponding with houses arranged in natural or retro style. Doors can be made on a 3- or 4-layer glued profile. They can be made on Ecoline, Thermoline, Ecotherm profiles, also with an aluminium overlay. The door is equipped with a FAM handle and an automatic espagnolette with three latches.

TECHNICAL DATA

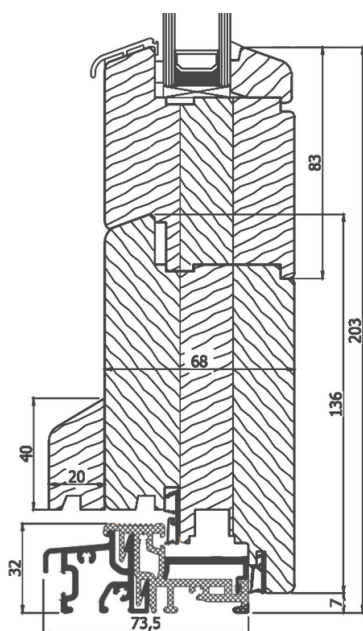

Frame thickness **68 mm / 92 mm**

Heat transfer coefficient **$U_f=1,4 \text{ W/m}^2\cdot\text{K}$ / $U_f=1,0\text{W/m}^2\cdot\text{K}$**

Gasket **Triple, middle with EPDM**

Available glazing unit thicknesses **24 mm - 32 mm / 24 mm - 56 mm**

Standard glazing **$4/16\text{Ar}/4$ [$R_w=32\text{dB}$, $L_t=82\%$, $g=65\%$]
 $4/12\text{Ar}/4/12/\text{Ar}/4$ [$R_w=32\text{dB}$, $L_t=71\%$, $g=50\%$]**

Profile structure **Glued 3- 4-ply scantling**

Standard handle **FAM**

Warranty **2 years for the structure**

Certifications **CE, ITB, ITT, FSC**

Turnaround **9-14 weeks**

MODELS AND DESIGNS OF ENTRANCE DOORS

Timber door designs are extremely diverse - from classic, elegant designs to modern and minimalist designs. Thanks to this, everyone can find the right model to suit their style and taste. Timber door not only brings coziness to the room, but also serves as a showcase of the house, leaving a lasting impression on visitors.

PANEL DOOR

In panel doors, the construction is based on a frame of glued laminated timber, to which panels made of rigid panels of waterproof plywood are attached, filled inside with a thermal insulation panel. The panels cover the entire door leaf, creating a uniform plane. Panels can be milled (with or without decorative inlays) and varied with glazing. Panel doors have simple forms, which stylistically fit perfectly into modern construction.



FRAME DOOR

Frame doors are considered timeless and universal. In their construction, you can see the characteristic frame in which their filling (panel with thermal insulation panel or glazing) is placed. The structure is stable and durable, and the classic appearance allows them to easily fit into different home arrangements.



All designs for panel and model frame doors can be seen in our "Timber door catalogue".

See the timber door catalogue by scanning the QR code.



TIMBER DOORS

with milling



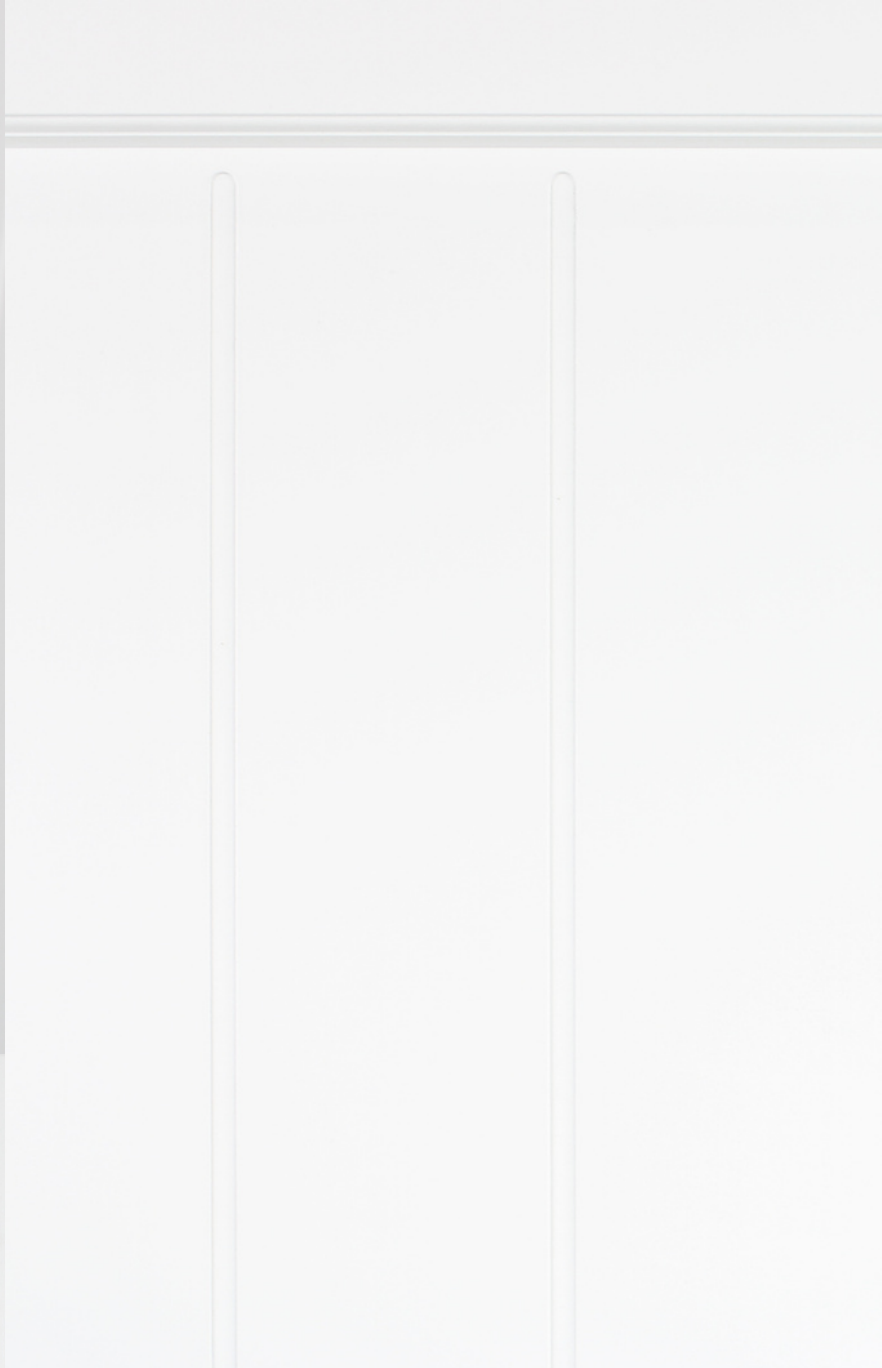

On the special order of our client, we made a white timber door with four frets. Meranti timber and ECOLINE 68 profile were used in their production. The door was decorated with four vertical milling, placed on both sides and evenly distributed across the width. In addition, they were equipped with white hinges, a handle, an aluminum threshold and a 3-point lock. The door will be the front door to the building and will open inward.

HANDLES AND PULL HANDLES

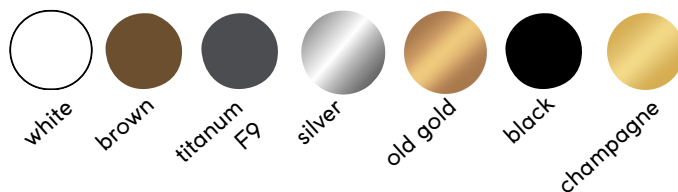

HANDLES FOR TIMBER WINDOWS



**Hoppe
Secustic Atlanta**
as standard



Square
available options:
with a lock with key, with button



**Hoppe
Secuforte Taulon**

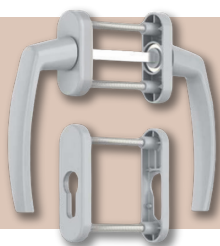

**double-sided
handle PZ35**



**HST
interior handle**
as standard



**HST
external pull handle**



HANDLES AND PULL HANDLES FOR TIMBER DOORS



H6S36
additional colours:
black anode



32/2200
additional colours:
black anode, inox



H6S26
additional colours:
black anode, inox



Q10
colours:
black anode, steel



P10
colours:
black anode; steel



Tg30 ER.GS
colours:
steel

For more handles, pull handles, as well as information on door fitting and accessories (inserts, peepholes, smart door opening systems, etc.), see our "Timber Door catalogue".

HST DOORS

Timber

thickness of glazing units
24 mm - 32 mm



frame thickness
173 mm lub 214 mm



HST system is available in depths: 173mm, 214mm, depending on this parameter the thickness of the glazing unit can be from 24mm to a maximum of 32mm. The timber HST system is available in multiple opening versions: up to 6 sashes, with a maximum weight of 400 kg each. In addition, it is possible to assemble electric drives, which can be controlled by a switch or remote control.

TECHNICAL DATA

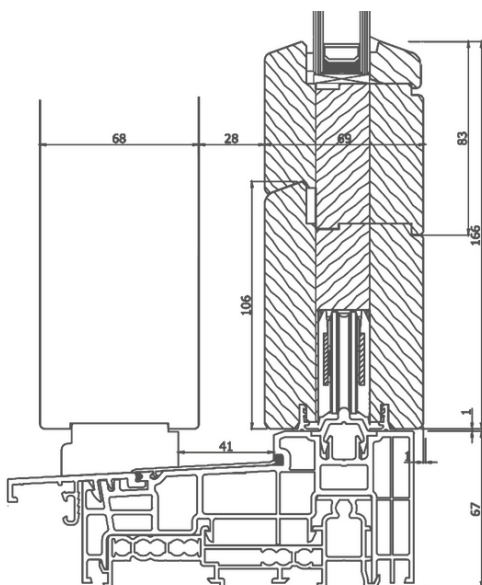

Frame thickness **173 mm, 214 mm**

Gasket **EPDM**

Available glazing unit thickness **24 mm - 32 mm**

Standard glazing **4/16Ar/4 [Rw=32dB, Lt=82%, g=65%]**

Profile structure **Laminated glued squared timber**

Standard handle **System handle**

Warranty **2 years on the structure**

Certifications **CE, ITB, ITT, FSC**

Turnaround **9 - 14 weeks**

COLOURS

Below is a palette of azure colours, which make the structure of the timber visible. Our products are also available in opaque colours - any colour from the RAL palette.

PINE TIMBER

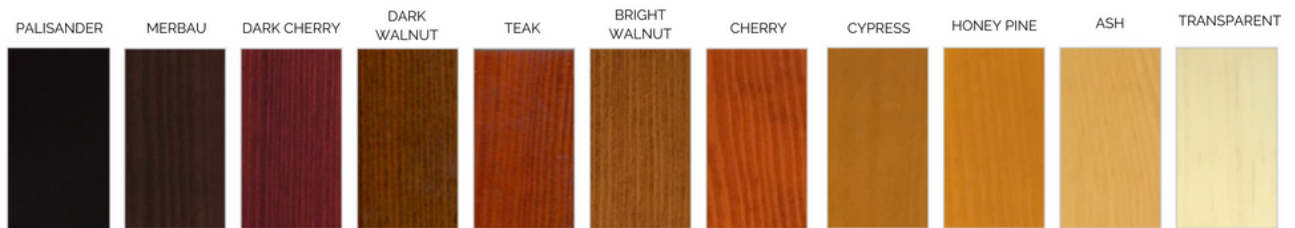

MERANTI TIMBER



OAK TIMBER



The colours presented in the catalogue only approximate the actual colours of the product.

SASH IN RAL 5009 COLOUR
Barano d'Ischia, Italy





This beautiful, unusual timber window SASH is made of jointed pine, has a small size - 480 x 1030 and a weight-assisted drive. The colour of the window - Atlantic blue/ azure blue (RAL 5009) - adds to the uniqueness. A huge visual advantage of this window is the extraordinary attention to detail - the springs have been masked by unusually shaped slats, the window has been equipped with fitting and accessories in silver matte colour.



EXTRA FEATURES



MUNTIN BARS

With muntins, the window gains a new dimension, emphasizing its geometric layout and giving it a unique expression.

Muntin bars are available in sizes: 20mm, 25mm, 30mm, 35mm and 40mm.

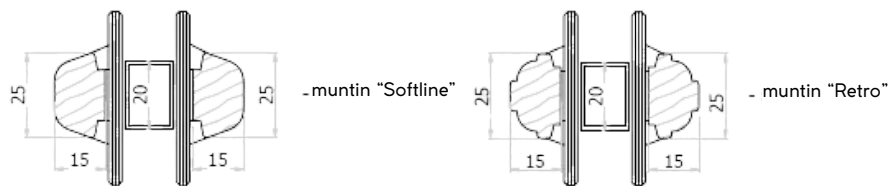

Types of muntin bars available: single-sided glued muntin bar, double-sided glued muntin bar or interglazed muntin bar.

DRIP EDGES AND SILLS

Properly selected quality of drip edges and sills allows not only to maintain the beauty of the building, but also provides long-term protection of the structure, increasing the value of the property and increasing the comfort of use.



timber sash drip edge

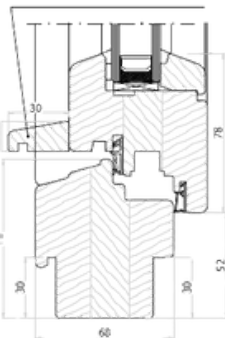

Belgian timber drip edge

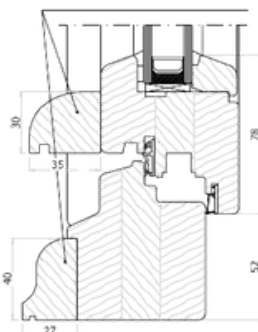

aluminium drip edge

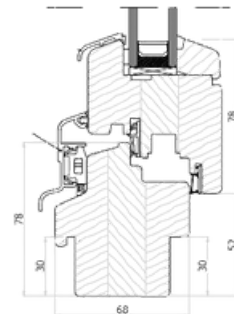

R6 window sill

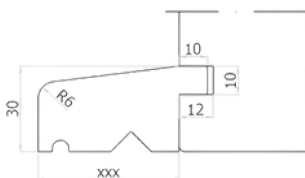

L-type sill

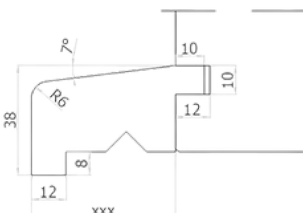

sill 95/120 mm

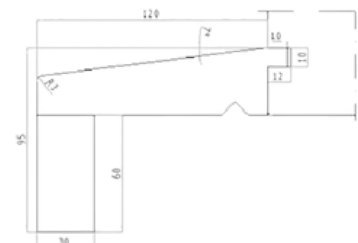

EXTRA FEATURES



PANELS

Windows and doors can be filled with a glazing or timber panels. In addition to the standard filling with a smooth surface, it is possible to make grooved, applied (plywood) and milled panels.

milled panel

WARM FRAME

A warm frame is a spacer separating the panes of glass made of a different, non-heat-conducting material such as plastic. Thanks to such frames, the troublesome effect of glass evaporation and heat loss is reduced. The frames come in several colours, which can be matched to the colour of the veneer and gaskets, enhancing the final visual effect of the window.

Colours of warm spacer bars:



White RAL 9016



Light gray RAL 7035



Light brown RAL 8003



Black RAL 9005



Dark brown RAL 8014

GLAZING

In addition to standard glazing, we offer a full range of ornamental glass.



See the full range of ornamental glass at Aikon Distributions by scanning the QR code:



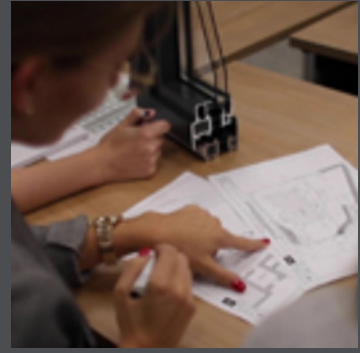

AiKON
DISTRIBUTION

A kon Distribution Bieg Żmuda Sp.k.
Łagiewnicka 25, 41-902 Bytom
Poland

www.aikondistribution.com

